



# Winnox Burners

Model WX0050

Version 1

## Main Specifications

PARAMETER		SPECIFICATIONS	
Blower Type		Packaged blower	Remote blower
Maximum input, BTU/hr (kW)   <b>Note:</b> Capacities given without air filter.  Contact factory for chamber pressures outside the given range, or varying chamber pressure conditions.	Chamber pressure "WC (mbar)	Nominal (60 Hz)	Pressure at air inlet 9" w.c. (22.5 mbar)
	-2.0 (-5.0)	620,000 (181)	650,000 (190)
	-1.0 (-2.5)	586,000 (171)	627,000 (183)
	<b>0.0</b>	<b>550,000 (161)</b>	<b>593,000 (173)</b>
	1.0 (2.5)	510,000 (149)	557,000 (163)
	2.0 (5.0)	468,000 (137)	518,000 (152)
Minimum input, BTU/hr (kW) <sup>3)</sup>	U.V. Scanner	50,000 (15)	
	Flame Rod	75,000 (22)	
Fuel inlet pressure at ratio regulator, "w.c. (mbar) <sup>1)</sup>	Maximum	27.7 (70)	27.7 (70)
	Minimum	22.0 (55)	26.0 (65)
Maximum chamber temperature, °F (°C)		Standard combustion tube: 1300 (704) High temp. combustion tube: 1550 (843) Refractory Plug: 1800 (982)	
Flame Length	Alloy Tube	Flame is inside tube at all inputs	
Excess Air, % at high fire		40%	
Piping		N.P.T. or B.S.P. burner piping available	
Flame detection		U.V. Scanner, Flame Rod	
Fuels		Natural gas <sup>2)</sup> For any other mixed gas, contact Eclipse Combustion	
Blower Motor Power, hp		.75	---
Weight, lbs (kg)	Alloy Tube	146 (66)	107 (49)
	Refractory Plug	137 (62)	98 (45)

1) For proper performance, this pressure must be kept constant across the burner operating range.

2) See Design Guide for more information about typical fuel composition and properties.

3) Minimum input may need to be increased to achieve maximum inputs above 550,000 Btu/hr (161 kW)

- All information is based on laboratory testing. Different chamber size and conditions will affect data.
- Maximum inputs for packaged blower versions are given for the standard combustion air blower without an inlet air filter.
- All inputs are based on gross calorific values and standard conditions: one atmosphere, 70° F (21° C)
- Eclipse reserves the right to change the construction and/or configuration of our products at any time without being obliged to adjust earlier supplies accordingly.

## Performance Graphs WX0050

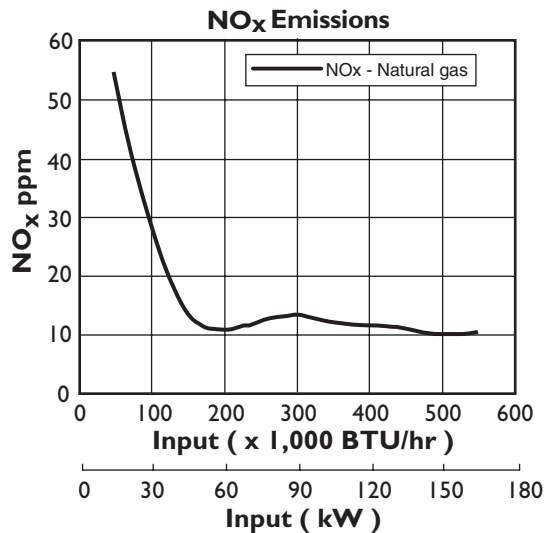
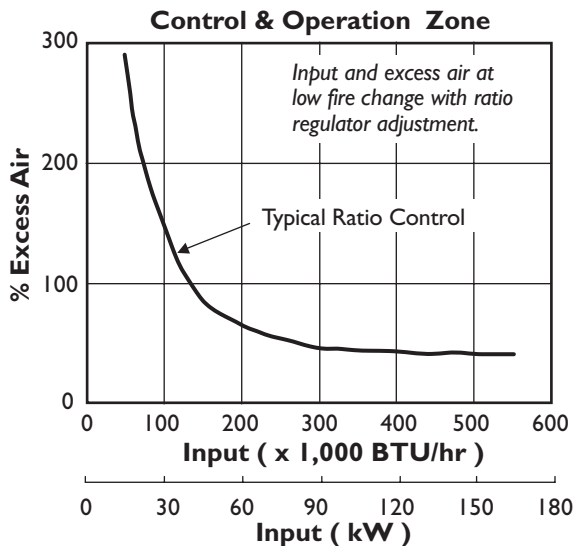

Input at low fire changes with ratio regulator adjustment.

**Secondary by-pass fuel setting:**

FUEL	FLAME DETECTION	$\Delta P$ "w.c. (mbar)*
Nat. Gas	U.V. Scanner	0.5 (1.2)
	Flame Rod	1.5 (3.7)

\* Measured between Tap "E" and the chamber @ low fire.

NO<sub>x</sub> emission data is given for:

- Ambient combustion air (~70 °F, 20 °C)
- Less than 1000 °F (540 °C) firing chamber
- Minimal process air velocity
- Low fire input adjusted to 50,000 BTU/hr (15kW)
- Neutral chamber pressure

- Emissions are influenced by:
- Chamber conditions
  - Fuel type
  - Firing rate
  - Ratio regulator adjustments
  - Combustion air temperature

CO emission is largely influenced by chamber conditions. Contact your local Eclipse Combustion representative for an estimate of CO emission on your application.

### Fuel / Input Measurement

System design must include fuel flow measurement upstream of the burner. Recommended is the Eclipse 4-5 FOM (Fuel Orifice Meter) assembly number 302084-5 for natural gas. See Bulletin 930 for details

Insure burner inlet pressures are met.

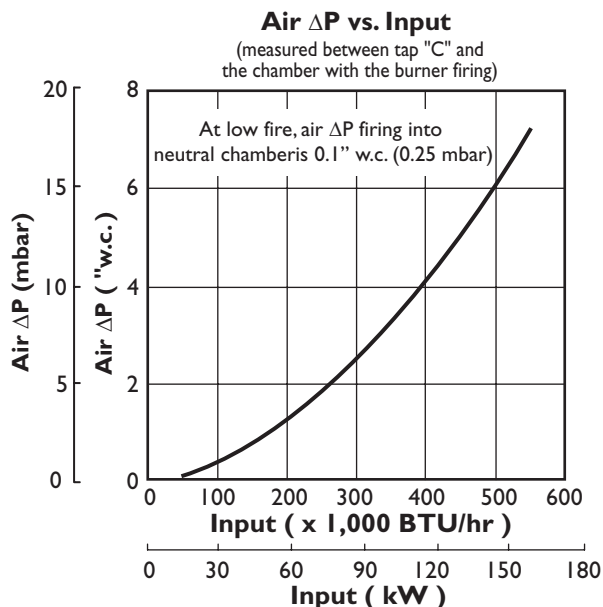

**Dimensions  
WX0050**

**Dimensions in mm (in)**

**Packaged Blower**

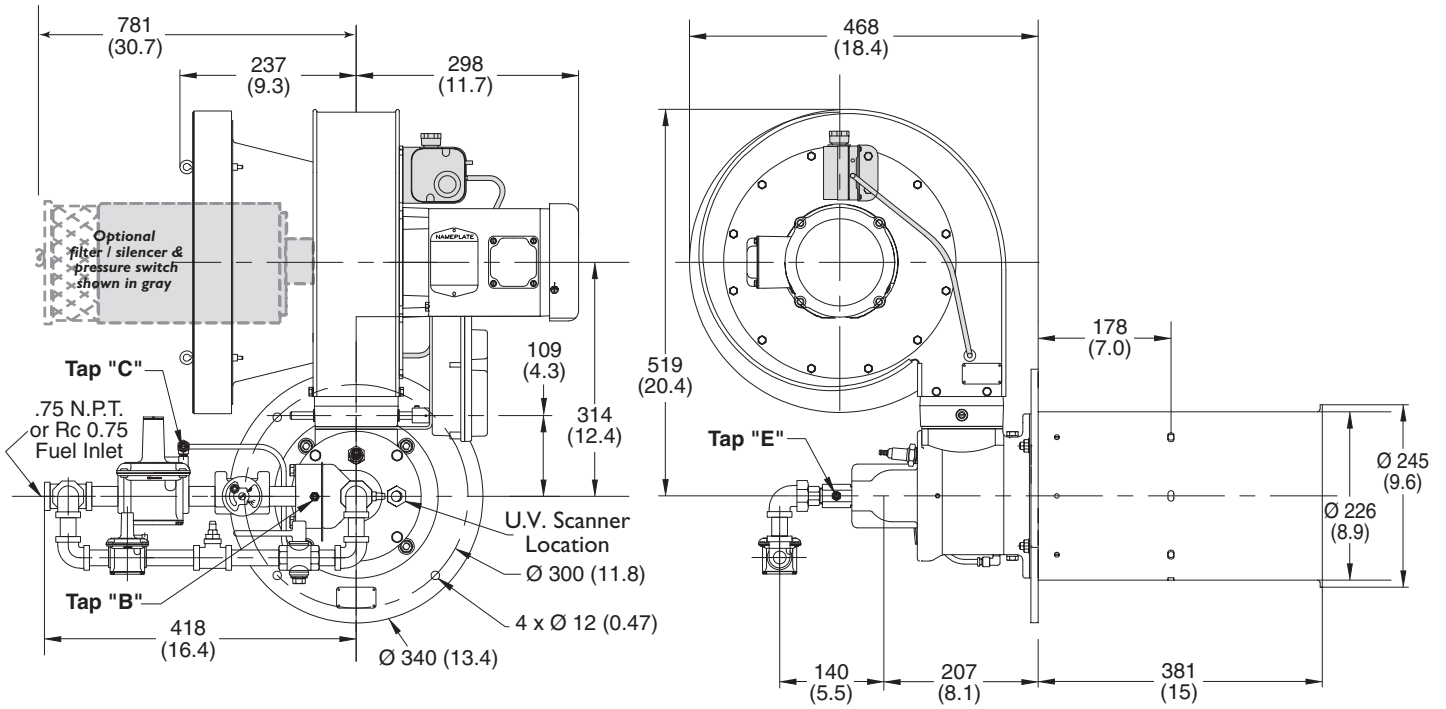

**Refractory Plug**

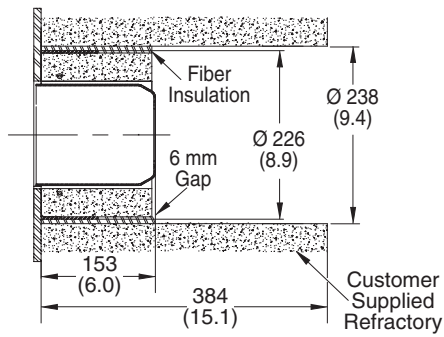

**Configured for Pilot**

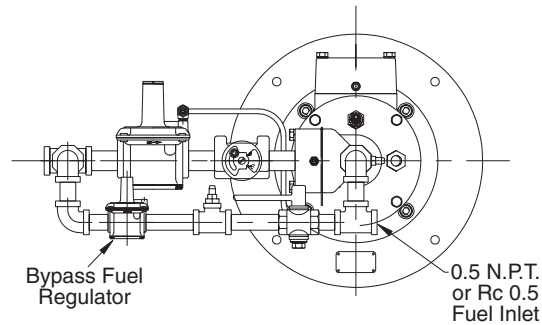

**Remote Blower**

 Note: For Remote Blower applications, consult factory.

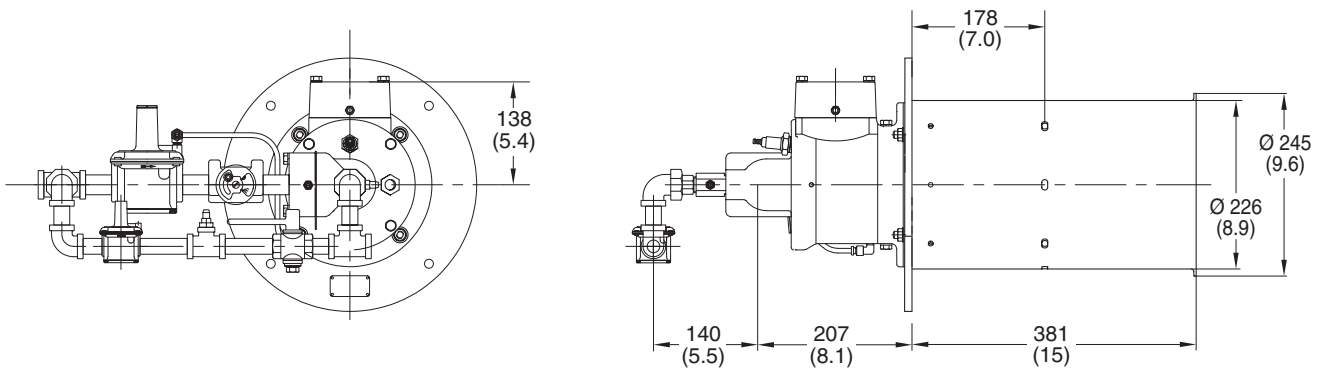



**Offered By:**

Power Equipment Company  
2011 Williamsburg Road  
Richmond, Virginia 23231  
Phone (804) 236-3800  
Fax (804) 236-3882

---

[www.peconet.com](http://www.peconet.com)